

# Williams Controls Electronic Floor Pedal, Multi Angle WM-537

The Electronic Floor Pedal WM-537 is designed for all commercial vehicle applications.

The WM-537 is equipped with a Hall-effect, non-contact sensor that can be programmed for analog output and/or integrated switches. The electronics are IP67 sealed and highly EMI resistant (SAE J1113). In addition, the unit can be customized with contact or PWM output sensors.

The WM-537 is available in three treadle angles: 30, 37.5 and 45 degrees. The base plate has five mounting holes for various mounting options.

This unit is made out of high strength engineered plastics and the treadle is supplied with a rubber cover for improved foot traction.



## SPECIFICATIONS

<b>PRODUCT LIFE</b>	Full Travel Cycles	3,000,000
<b>ELECTRONICS</b>	Seal Integrity EMI	Electronics IP67 sealed (IEC 60529) SAE J1113 Compliant
<b>ELECTRICAL</b>	Operating Voltage Output Signal	5V and 12V-24V Dual APS, Dual PWM, APS, PWM, APS/IVS
<b>PEDAL ANGLE</b>	Degrees	30°, 37.5°, 45°
<b>MECHANICAL</b>	Static Load Vibration	1500N 3 hour, 3-axis, random broadband up to 4g
<b>ENVIRONMENTAL</b>	Operating Temp Range Storage Temp Range Humidity Sand/Dust	-40°C to 85°C -40°C to 85°C 95% RH for 120 hours, 27°C to 75°C Tested to SAE J1455
<b>MATERIALS</b>	Main Body Mounting Plate Treadle Cover	Composite Plastic Composite Plastic NBR Rubber

## MECHANICAL DIMENSIONS (mm)

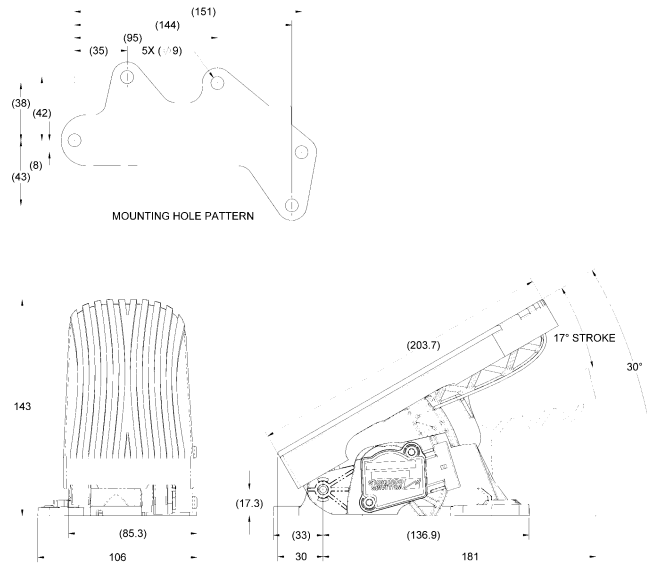

## TYPICAL OUTPUT CHARACTERISTICS (other outputs are available)

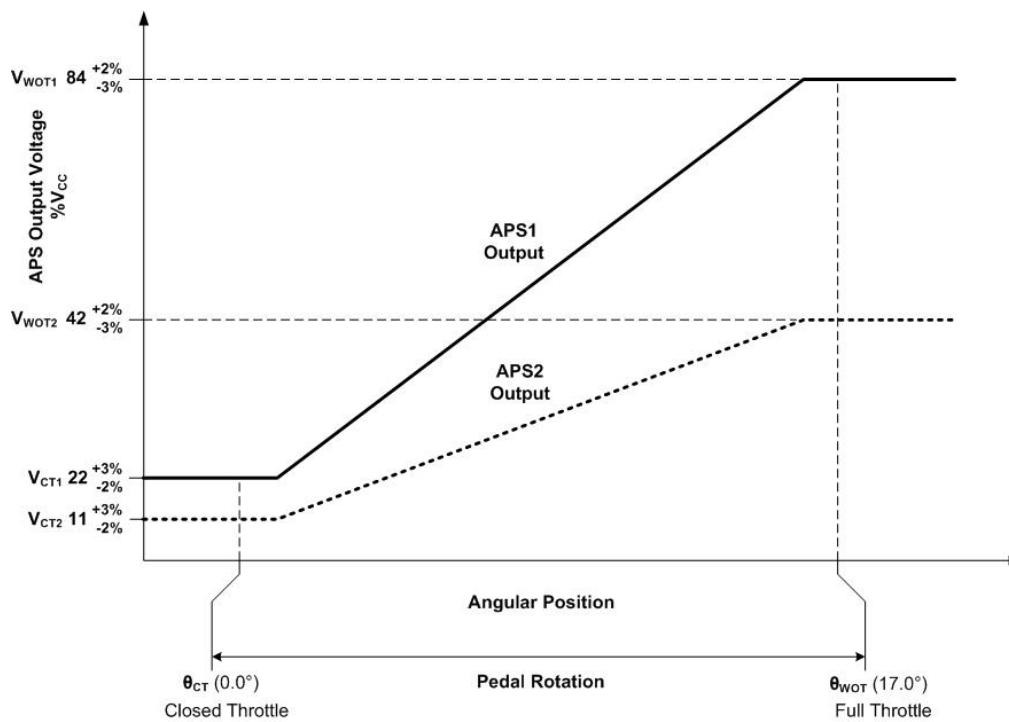

© 2014 Curtiss-Wright. All rights reserved. Specifications are subject to change without notice.  
All trademarks are property of their respective owners.

WM537-11/14

**CURTISS-  
WRIGHT**

**USA** Portland  
Oregon  
T: +1.509.684.8600  
F: +1.503.684.3879  
cwig.us@curtisswright.com  
www.cw-industrialgroup.com

**Europe** Christchurch  
United Kingdom  
T: +44.1425.271444  
F: +44.1425.272655  
cwig.uk@curtisswright.com  
www.cw-industrialgroup.com

**Asia** Shanghai  
China  
T: +86.213.3310670  
cwig.cn@curtisswright.com  
www.cw-industrialgroup.com