

1540 X - X - X - X - X - X X

A - STANDARD BUSSMANN LABEL
B-Z - PRIVATE LABEL

LABEL
0 - STANDARD LABEL
1 - 1ST NON-STANDARD LABEL
2 - 2ND NON-STANDARD LABEL

COVER
0 - NO COVER
1 - STANDARD COVER WITH BUSSMANN LOGO
(CONSULT FACTORY FOR SPECIAL OPTIONS)

HARDWARE
0 - W/O NUTS
1 - NUTS SHIPPED BULK
2 - NUTS SHIPPED ASSEMBLED

BASE
1 - BASE WITH ENGLISH MTG INSERTS AND CABLE MANAGERS
2 - BASE WITH ENGLISH MTG INSERTS WITHOUT CABLE MANAGERS
3 - BASE WITH METRIC MTG INSERTS AND CABLE MANAGERS
4 - BASE WITH METRIC MTG INSERTS WITHOUT CABLE MANAGERS

BUS BARS
1 - DUAL BUS BARS
2 - BUS BAR LEFT HAND SIDE ONLY (NOT AVAILABLE AT THIS TIME)
3 - BUS BAR RIGHT HAND SIDE ONLY (NOT AVAILABLE AT THIS TIME)
4 - NO BUS BARS

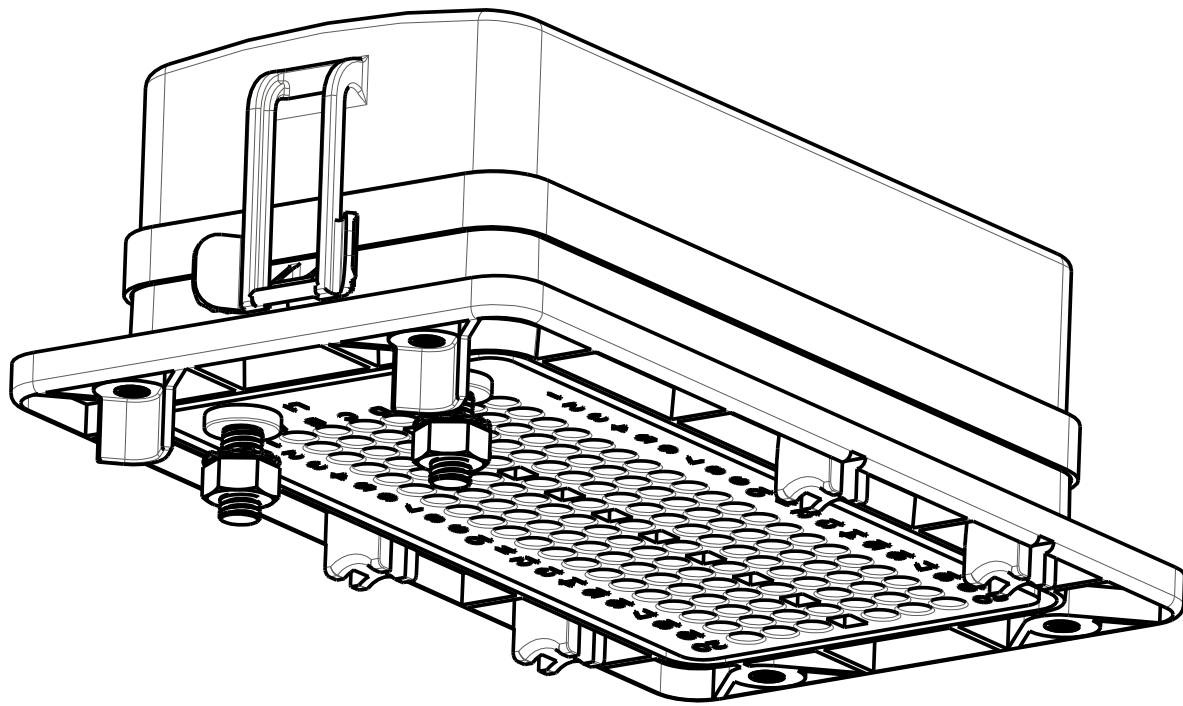
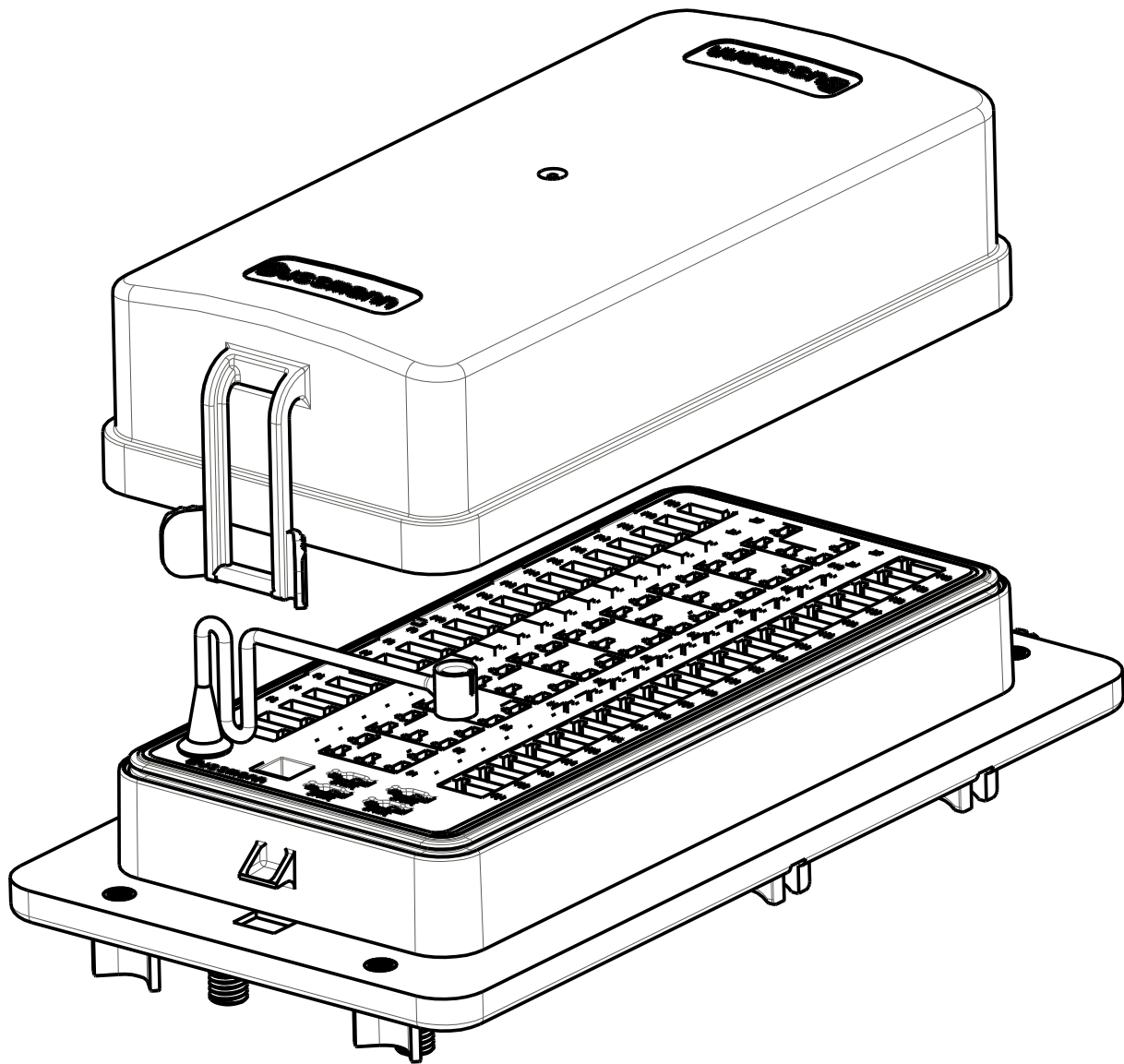

- NOTES:
1. MATERIAL: PLASTIC IS RATED AT 94V0
BUS BAR IS TIN PLATED COPPER
 2. INGRESS PROTECTION RATING: IP66 WHEN USED WITH COVER, SEALED TERMINALS & CAVITY PLUGS.
 3. RATING: 100A PER BUS BAR, 200A MAX TOTAL FOR UNIT.
 4. TERMINATION: FOR USE WITH DELPHI 280 SERIES METRI-PACK TANG STYLE TERMINALS.
SEALS AND CAVITY PLUGS REQUIRED FOR SEALED APPLICATIONS.
 5. PDM CAPABLE OF HOLDING 10 RELAYS AND A COMBINATION OF 40 FUSES/CIRCUIT BREAKERS.
 6. PDM CAN BE USED AS A FULLY BUSSED, PARTIALLY BUSSED OR NON-BUSSED.
(NON-BUSSED AND PARTIALLY BUSSED NOT AVAILABLE AT THE PRESENT TIME)
 7. THREADED MOUNTING INSERT TIGHTENING TORQUE 24 LBF-IN MAX.
 8. INPUT STUD TIGHTENING TORQUE 70 LBF-IN MAX.
 9. TERMINAL REMOVAL TOOL DELPHI PART NUMBER 12094429 OR 12099430.

REV	DESCRIPTION	DATE	APPR
0	RELEASED TO SALES	05-26 2009	
1	SHEET 2: 197.5 WAS 197.9, 124.4 WAS 124.0, 94.3 WAS 94.9	06-26 2009	
2	CHANGED SERIES NUMBER FROM 1532X TO 154XX, REMOVED EXTRA VIEWS & LOCAL NOTES ECN BU-U09122 KF	07-21 2009	
3	DELETED MRFM REFERENCE ECN BU-U09172 JS	11-05 2009	
4	SHEET 2: (C-5) ADDED 65.4 REF & (B-5) ADDED 25.6 REF ECN BU- N10011 KF	02-16 2010	
5	REMOVED "NOT AVAILABLE AT THIS TIME" FROM BUS BAR OPTION 4 AND PART NO. 1540X-X-X-X-XX WAS 154XX-X-X-X-XX. BU-U10145 A.L	08-25 2010	

1540 X - X - X - X - X - X X

A - STANDARD BUSSMANN LABEL
B-Z - PRIVATE LABEL

LABEL
0 - STANDARD LABEL
1 - 1ST NON-STANDARD LABEL
2 - 2ND NON-STANDARD LABEL

COVER
0 - NO COVER
1 - STANDARD COVER WITH BUSSMANN LOGO
(CONSULT FACTORY FOR SPECIAL OPTIONS)

HARDWARE
0 - W/O NUTS
1 - NUTS SHIPPED BULK
2 - NUTS SHIPPED ASSEMBLED

BASE
1 - BASE WITH ENGLISH MTG INSERTS AND CABLE MANAGERS
2 - BASE WITH ENGLISH MTG INSERTS WITHOUT CABLE MANAGERS
3 - BASE WITH METRIC MTG INSERTS AND CABLE MANAGERS
4 - BASE WITH METRIC MTG INSERTS WITHOUT CABLE MANAGERS

BUS BARS
1 - DUAL BUS BARS
2 - BUS BAR LEFT HAND SIDE ONLY (NOT AVAILABLE AT THIS TIME)
3 - BUS BAR RIGHT HAND SIDE ONLY (NOT AVAILABLE AT THIS TIME)
4 - NO BUS BARS

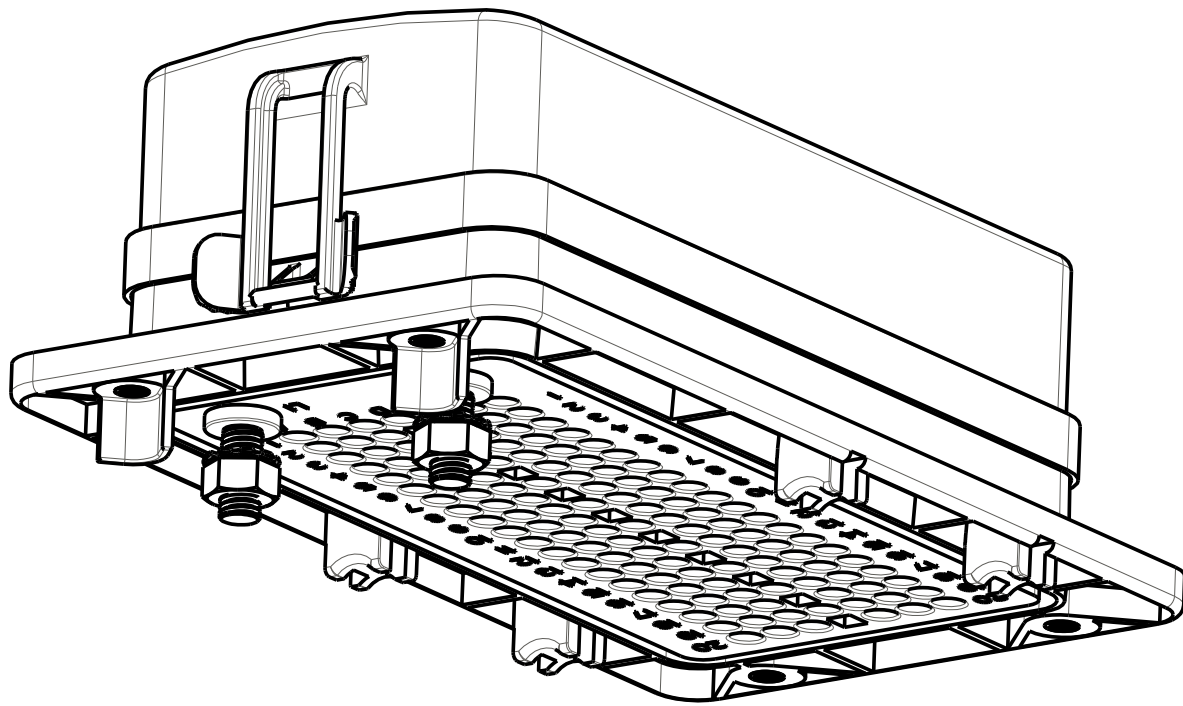
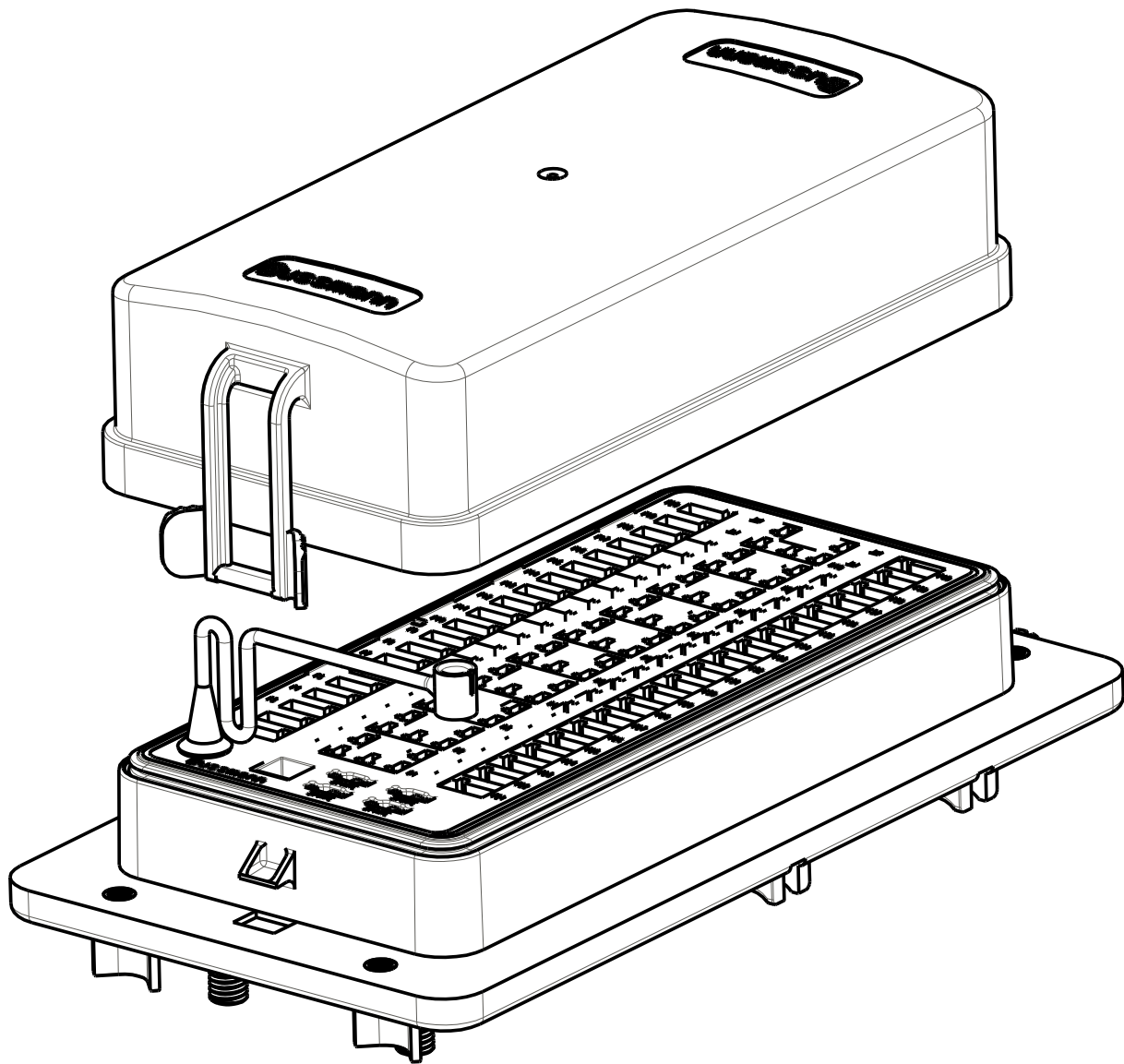

NOTES:
1. MATERIAL: PLASTIC IS RATED AT 94V0
BUS BAR IS TIN PLATED COPPER
2. INGRESS PROTECTION RATING: IP66 WHEN USED WITH COVER, SEALED TERMINALS & CAVITY PLUGS.
3. RATING: 100A PER BUS BAR, 200A MAX TOTAL FOR UNIT.
4. TERMINATION: FOR USE WITH DELPHI 280 SERIES METRI-PACK TANG STYLE TERMINALS.
SEALS AND CAVITY PLUGS REQUIRED FOR SEALED APPLICATIONS.
5. PDM CAPABLE OF HOLDING 10 RELAYS AND A COMBINATION OF 40 FUSES/CIRCUIT BREAKERS.
6. PDM CAN BE USED AS A FULLY BUSSED, PARTIALLY BUSSED OR NON-BUSSED.
(NON-BUSSED AND PARTIALLY BUSSED NOT AVAILABLE AT THE PRESENT TIME)
7. THREADED MOUNTING INSERT TIGHTENING TORQUE 24 LBF-IN MAX.
8. INPUT STUD TIGHTENING TORQUE 70 LBF-IN MAX.
9. TERMINAL REMOVAL TOOL DELPHI PART NUMBER 12094429 OR 12099430.

REV	DESCRIPTION	DATE	APPR
5	SEE SHEET NO. 1	08-25 2010	

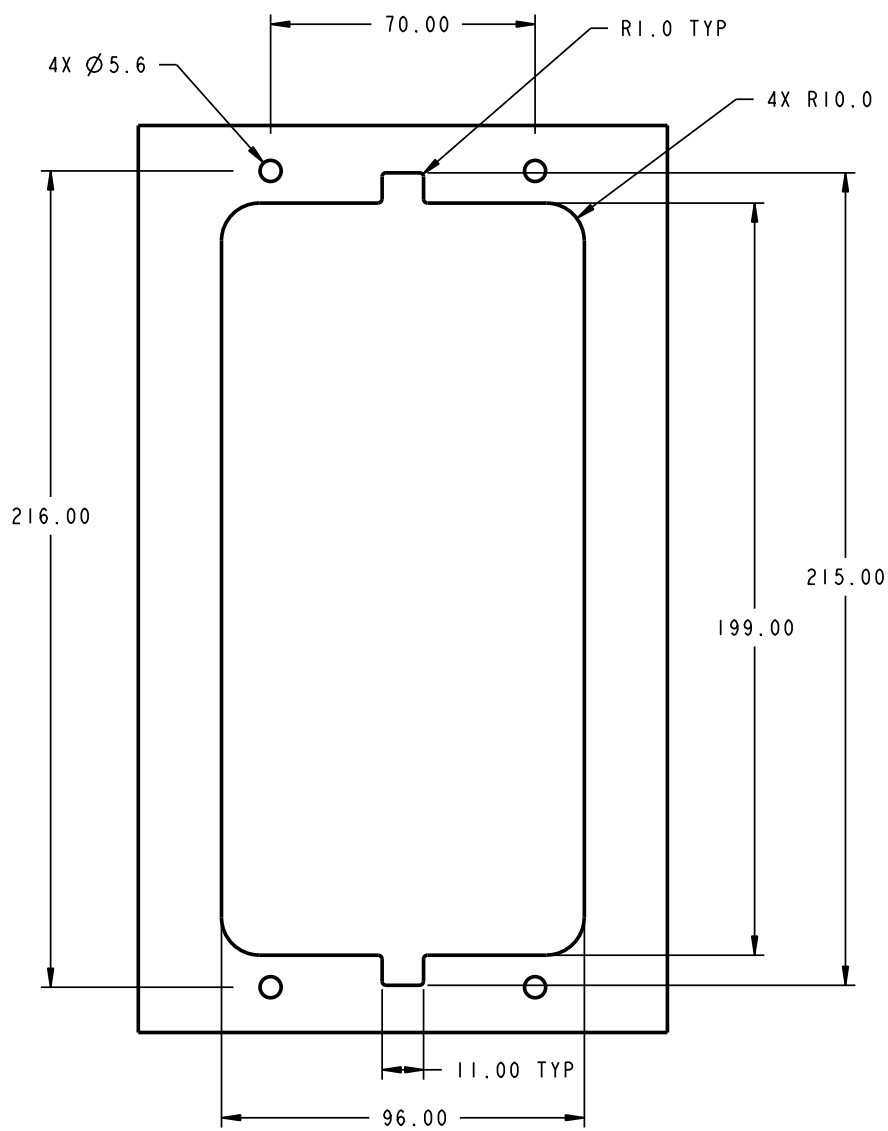
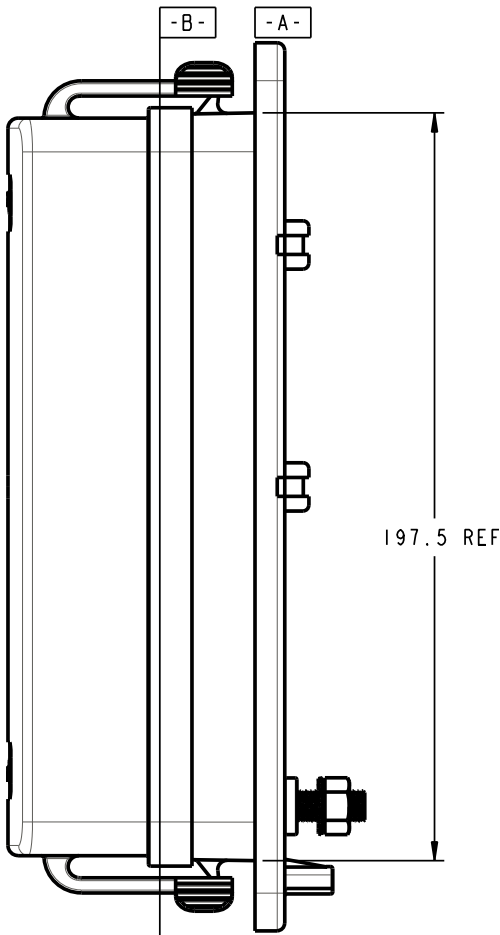
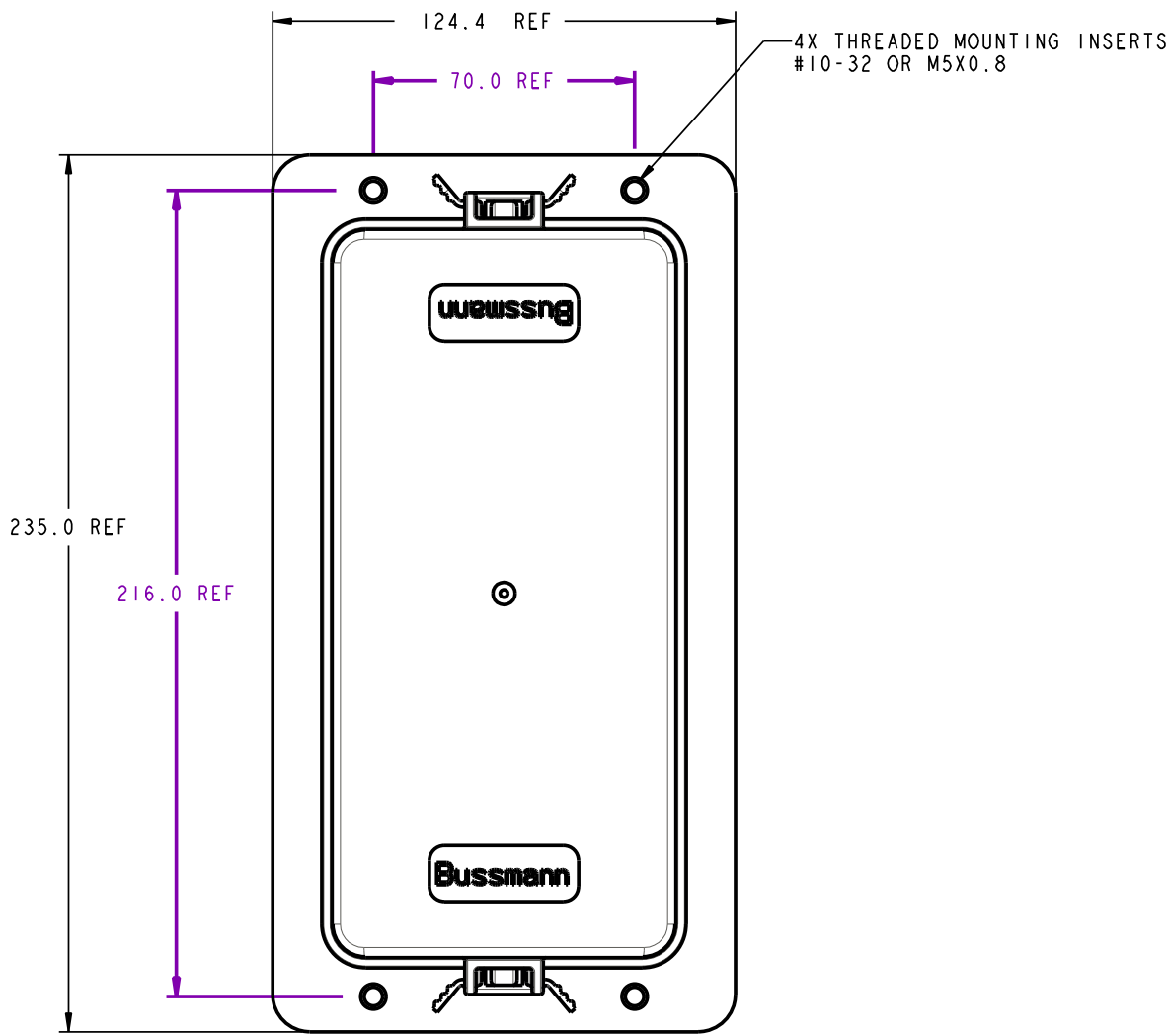

TYPICAL CUT-OUT FOR MTG. GLOBAL PDM
SCALE: 1:1

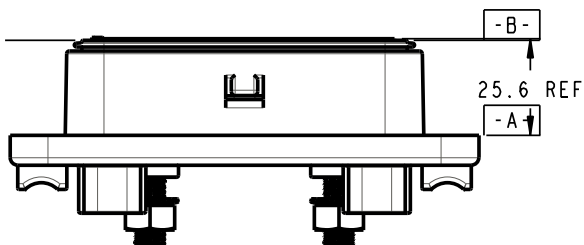
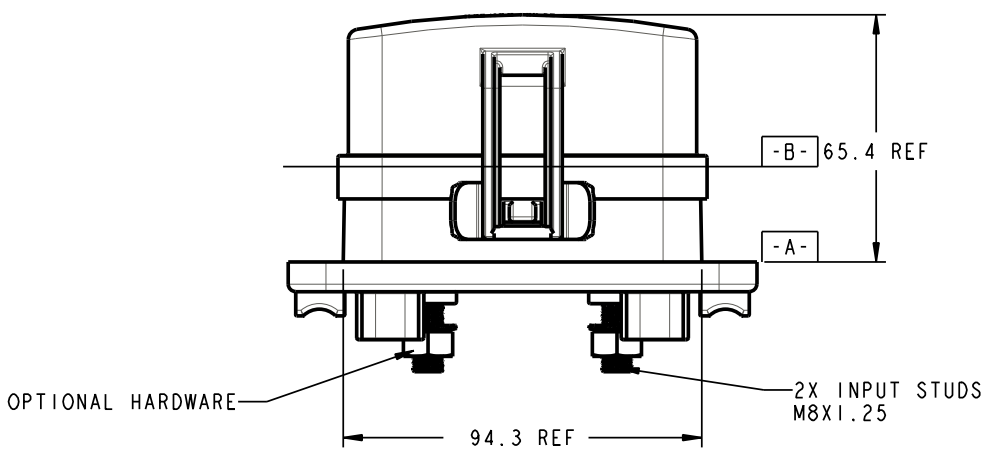

FUSE POSITION F20
CORRESPONDS TO A20

CORRESPONDS TO
FUSE POSITION F40

CORRESPONDS TO
FUSE POSITION F20

FUSE POSITION F1
CORRESPONDS TO A1

FUSE POSITION F40
CORRESPONDS TO G20

FUSE POSITION F21
CORRESPONDS TO G1

CORRESPONDS TO
FUSE POSITION F21

CORRESPONDS TO
FUSE POSITION F1

TOP VIEW
SHOWING LABEL

BOTTOM VIEW
SHOWING WIRE MARKING