

ITEM	QTY	DESCRIPTION	RATIOS ▶		SGL PLANETARY								DOUBLE PLANETARY							
			4:1	6:1	13.54:1	28.32:1	33.00:1	36.00:1	36.00:1	45.00:1	4:1	6:1	13.54:1	28.32:1	33.00:1	36.00:1	36.00:1	45.00:1		
		A130 - ROUND FLANGE	81-004-0342																	
		B130 - SQUARE FLANGE	81-004-0592																	
		E130 - RECTANGULAR	81-004-3072																	
		F130 - FLANGELESS	81-004-1142																	
		C130 - CUSTOM																		
2	1	D1 23 T 8/16 DP SPL 2.25" LG	81-004-1392L																	
		D2 3.000" DIA, 5/8" SQ KEY	81-004-0992L																	
		D3 23 T 8/16 DP SPL 1.22" LG	81-004-1412L																	
		D4 23 T 8/16 DP SPL 2.72" LG	81-004-0942L																	
		D5 3.500" DIA, 7/8" SQ KEY	81-004-1152L																	
		C1 CUSTOM																		
3	1	SAE 'A' 2 & MOD. 4 BOLT			13-004-1192	13-004-1192	13-004-1222			13-004-1192	13-004-1222									
		SAE 'A' 2 & MOD. 4 BOLT W/ CODE 4	13-004-1252	13-004-1252	13-004-1252	13-004-1222	13-004-1222			13-004-1222										
		SAE 'B' 2 BOLT			13-004-1182	13-004-1182	13-004-1232			13-004-1182	13-004-1232									
		SAE 'B' 2 & 4 BOLT W/ CODE 4	13-004-1202	13-004-1202	13-004-1202	13-004-1232	13-004-1232			13-004-1232										
		SAE 'C' 2 BOLT & 4 BOLT	13-004-1212	13-004-1212	13-004-1212	13-004-1242	13-004-1242			13-004-1212	13-004-1242									
		SAE 'D' 4 BOLT W/ CODE 9	13-004-1412																	
4	1	CODE 2 - INPUT - 13 T 16/32 DP			13-004-1292	13-004-1292	13-004-1312			13-004-1302	13-004-1312									
		CODE 3 - INPUT - SAE 1"-6B			13-004-1322	13-004-1322	13-004-1472			13-004-1332	13-004-1472									
		CODE 4 - INPUT - 14 T 12/24 DP	13-004-1372	13-004-1382	13-004-1342	13-004-1342	13-004-1362	13-004-1352			13-004-1362									
		CODE 5 - INPUT - 15 T 16/32 DP			13-004-1452	13-004-1452	13-004-1802			13-004-1442	13-004-1802									
		CODE 9 - INPUT - 13 T 8/16 DP	13-004-1402		13-004-1512															
5	(1)	CARRIER ASSEMBLY-SECONDARY	13-005-2001	13-005-2011	13-005-2001	13-005-2011	13-005-2001	13-005-2011	13-005-2011	13-005-2011										
5A	1	CARRIER (SEC)	13-004-1082																	
5B	3	PLANET GEAR (SEC)	13-004-1082																	
5C	3	PLANET SHAFT (SEC)	81-004-0061																	
5D	6	BRG - SEC. PL.	01-105-0500																	
5E	6	THRUST WASHER - PLANET	81-004-1561																	
5F	3	ROLL PIN - SEC. PL. 3/16 X 7/8	01-153-0210																	
6	1	SUN GEAR			13-004-1142	13-004-1152	13-004-1142	13-004-1152	13-004-1152	13-004-1152										
7	(1)	CARRIER ASSEMBLY-PRIMARY			13-005-2021	13-005-2021	13-005-2041	13-005-2031	13-005-2031	13-005-2041										
7A	1	CARRIER (PRI)			13-004-1032	13-004-1032	13-004-1052	13-004-1042	13-004-1042	13-004-1052										
7B	3	PLANET GEAR (PRI)			13-004-1102	13-004-1102	13-004-1122	13-004-1112	13-004-1112	13-004-1122										
7C	3	PLANET SHAFT (PRI)			13-004-1021															
7D	3	BRG - PRI. PL.			01-105-0590															
7E	6	THRUST WASHER - PLANET			81-004-1561															
7F	3	ROLL PIN - PRI. PL. 1/8 X 7/8			01-153-0180															
7F	3	ROLL PIN - SEC. PL. 3/16 X 7/8			01-153-0210															
12	1	RING GEAR			81-004-2362															
14	-	THRUST WASHERS & THRUST BRGS																		
14A	1	CARRIER THRUST WASHER			81-004-2711															
14B	1	CARRIER THRUST WASHER	81-004-2711																	
14C	1	INPUT THRUST WASHER	81-004-2883		81-004-2701	81-004-2701			81-004-2701											
14D	1	THRUST WASHER SGL PL.	01-112-0030																	
14E	1	BEARING					01-112-0220	01-112-0220			01-112-0220									
14F	2	THRUST RACE					01-112-0230	01-112-0230			01-112-0230									
16	(1)	SEAL KIT			81-016-2941															
16A	1	SHAFT SEAL -			01-405-0270															
16B	2	O-RING			01-402-0420															
20	-	OUTPUT SHAFT BEARINGS																		
20A	1	OUTER CONE			01-102-0020															
20B	1	OUTER CUP			01-103-0020															
20C	1	INNER CONE			01-102-0030															
20D	1	INNER CUP			01-103-0030															
25	-	HARDWARE																		
25A	8	BOLTS - COVER			01-150-1670 (FOR 13-004-1412 COVER, USE 01-150-1710 SHCS)															
25B	8	LOCKWASHERS - COVER			01-166-0010 (FOR 13-004-1412 COVER, DO NOT USE LOCKWASHERS)															
25C	16	BOLTS - RING			01-150-1460															
25D	16	HARD WASHERS - RING			01-166-0120															
30	-	PLUGS /GREASE ZERK																		
30A	1	PLUG - COVER			01-207-0070															
30B	2	PLUG - RING			01-207-0041															
30C	1	1/4 NPT (SOC. HD.)			01-207-0020															
30C	1	GREASE FITTING			01-215-0040															
35	-	MISCELLANEOUS																		
35A	*	SHIMS	80-004-1151		(* QUANTITY DETERMINED BY PRELOAD REQUIRED AND PART STACK-UP)															
35B	1	SPLIT RING			81-004-8101															
35C	1	LOCK RING			81-004-8111															
35D	1	RETAINING RING	01-160-0040																	

** SAE "D" COVER IS SOLD ONLY WITH A CODE 9, 13 T- 8/16 INPUT GEAR.

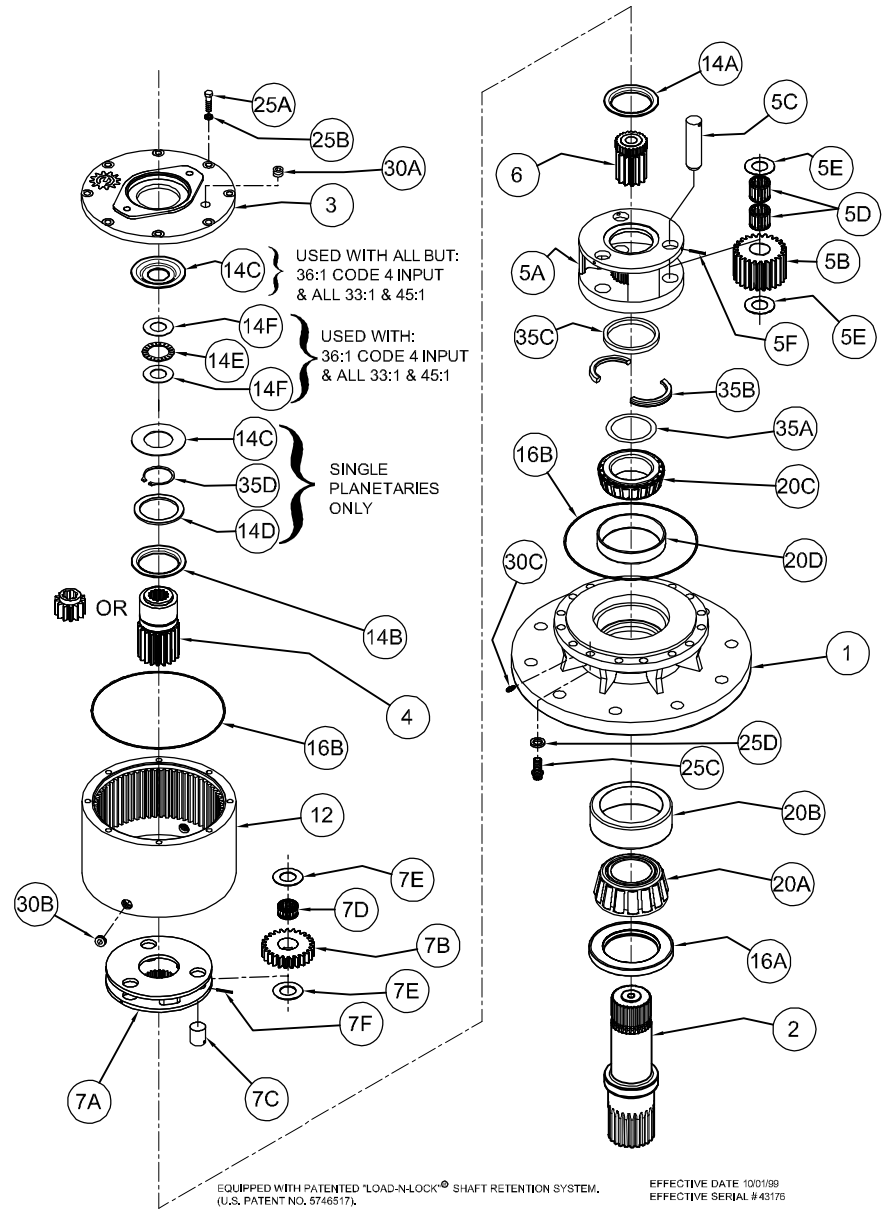

X130LD2-AH DATE 10-22-12
ECN 3483E